

SECTION B-B

SCALE: VERT. 1" = 100'
HORIZ. 1" = 1000'

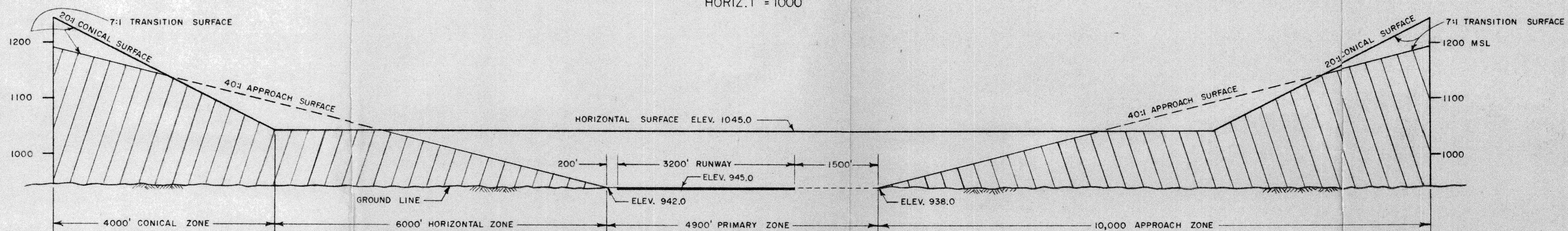

SECTION A-A

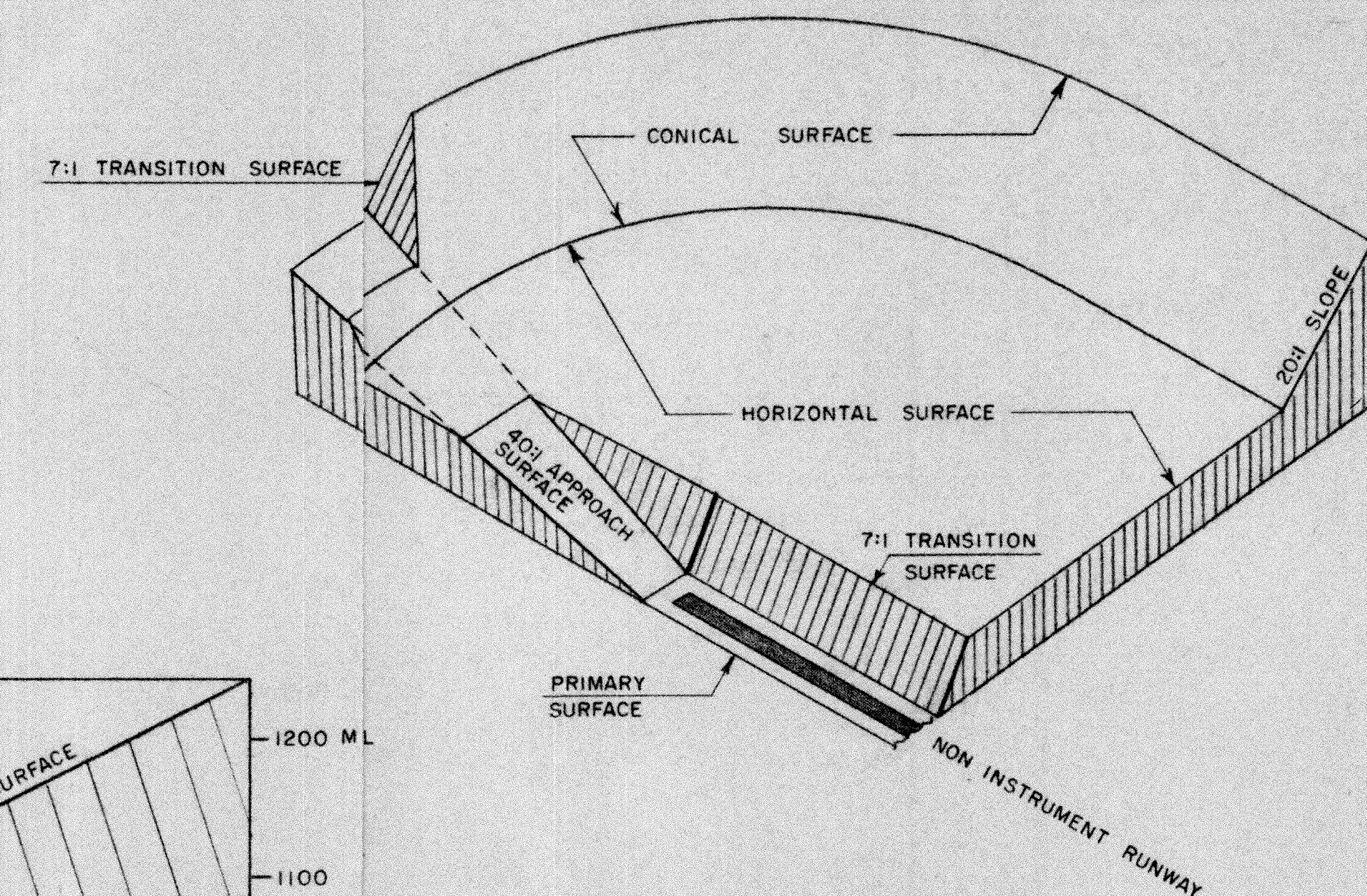

PERSPECTIVE VIEW SHOWING
IMAGINARY SURFACES
NO SCALE

CAMBRIDGE MUNICIPAL
AIRPORT

CAMBRIDGE, MINNESOTA

AIRSPACE SECTIONS

SHEET NO. 2 OF 3 SHEETS

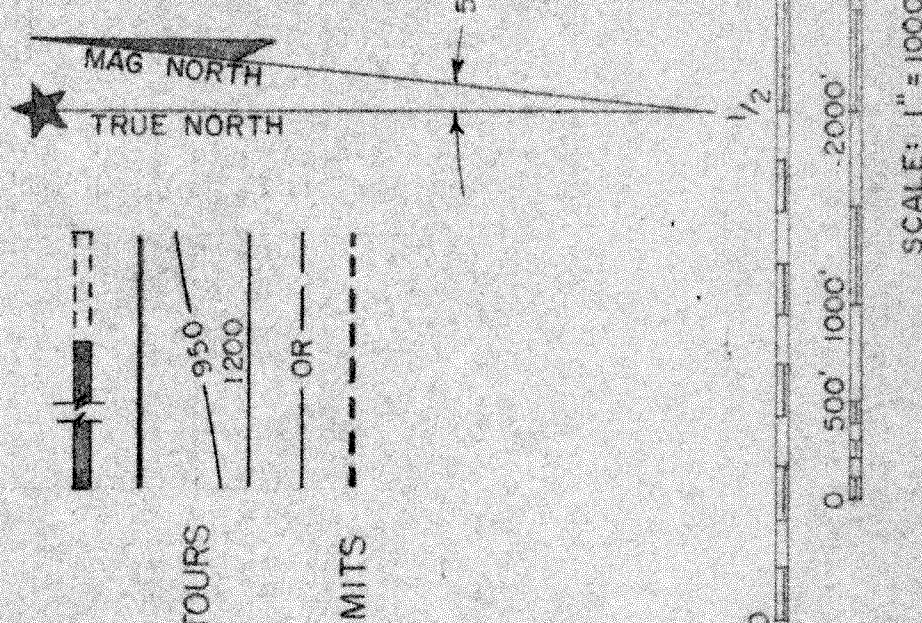
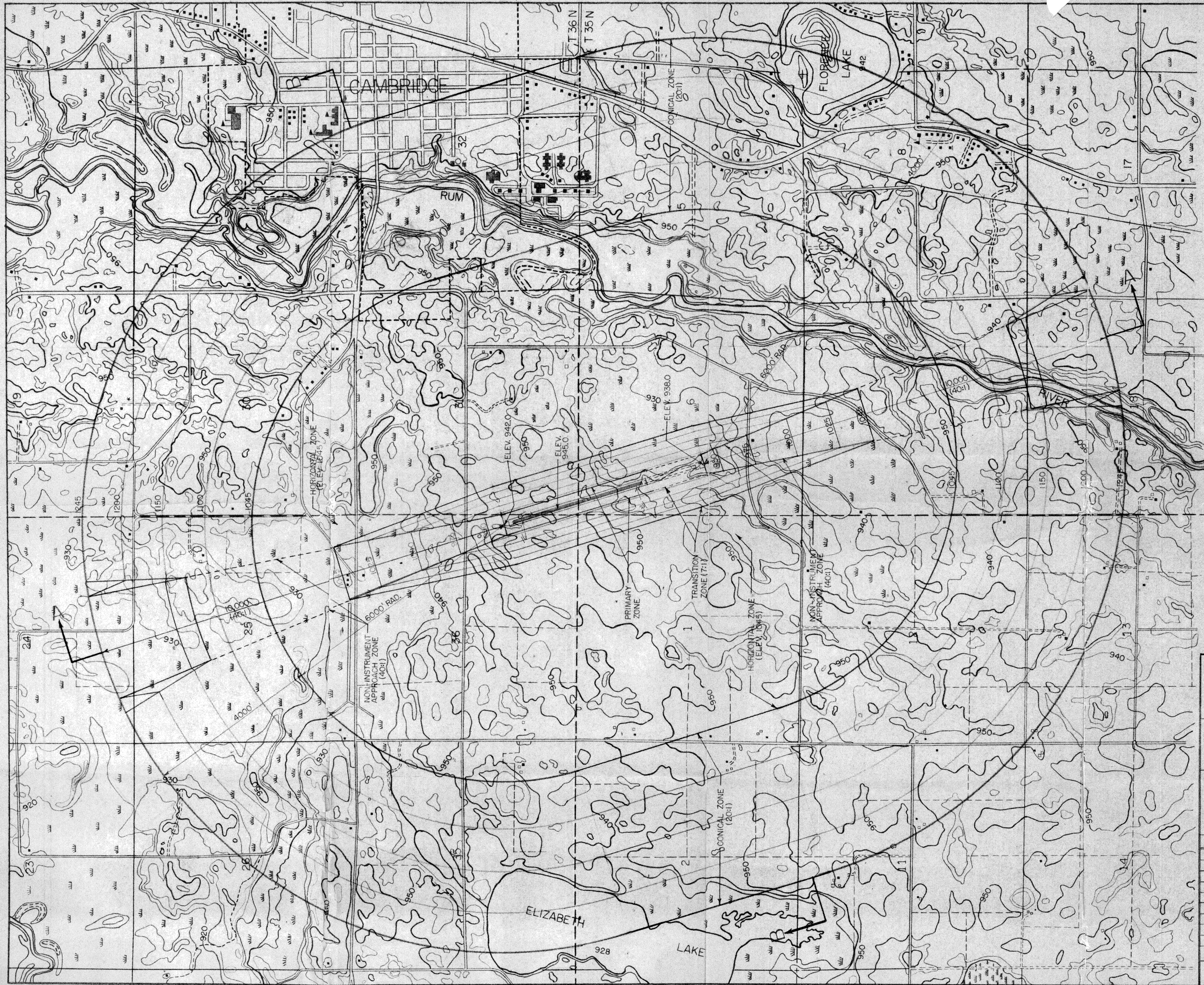

- ULTIMATE RUNWAY
- ZONE BOUNDARY
- TOPOGRAPHIC CONTOURS
- AERIAL CONTOURS
- SECTION LINES
- CAMBRIDGE CORP. LIMITS

- NOTES:
1. TOPOGRAPHIC CONTOUR INTERVALS ARE 10 FEET DATUM IS MEAN SEA LEVEL ELEVATION.
 2. THE AERIAL CONTOURS ILLUSTRATE THE HEIGHT LIMITATIONS WITHIN EACH ZONE.
 3. A SLOPE, SUCH AS 40:1, EXPRESSES THE HORIZONTAL DISTANCE OF 40 FEET TO THE VERTICAL DISTANCE OF 1 FOOT.
 4. EXISTING TOPOGRAPHIC SYMBOLS ARE THOSE USED BY THE U.S. GEOLOGICAL SURVEY.
 5. IN THOSE AREAS WHERE EXISTING TERRAIN OR TREES PENETRATE OR INTERFERE WITH THE IMAGINARY SURFACES OF THE CONTOUR STRUCTURES, THE TREE RESTRICTED ONLY TO THE HEIGHT OF THE TREE CANOPY WHICH PROVIDES A NATURAL SHIELD TO THE STRUCTURE.

CAMBRIDGE MUNICIPAL AIRPORT
CAMBRIDGE, MINNESOTA

VILLAGE - COUNTY JOINT AIRPORT ZONING COMMISSION

APPROVAL _____ DATE _____

RALPH D. THOMAS & ASSOC. INC.
ENGINEERS
9 N. 4TH. ST. MINNEAPOLIS, MINN.

REVISIONS		
NO.	DESCRIPTION	DATE

DATE	9/18/73	I HEREBY CERTIFY THAT THIS PLAN, SPECIFICATION, OR REPORT WAS PREPARED BY ME OR UNDER MY DIRECT SUPERVISION AND THAT I AM A DULY REGISTERED ENGINEER UNDER THE LAWS OF THE STATE OF MINN.
DRAWN	RDR	
CHECKED	L.E.G.	
APPROVED	H	
PROJECT NO.	7319	

AIRSPACE ZONING PLAN
SHEET NO. 1 OF 3 SHEETS

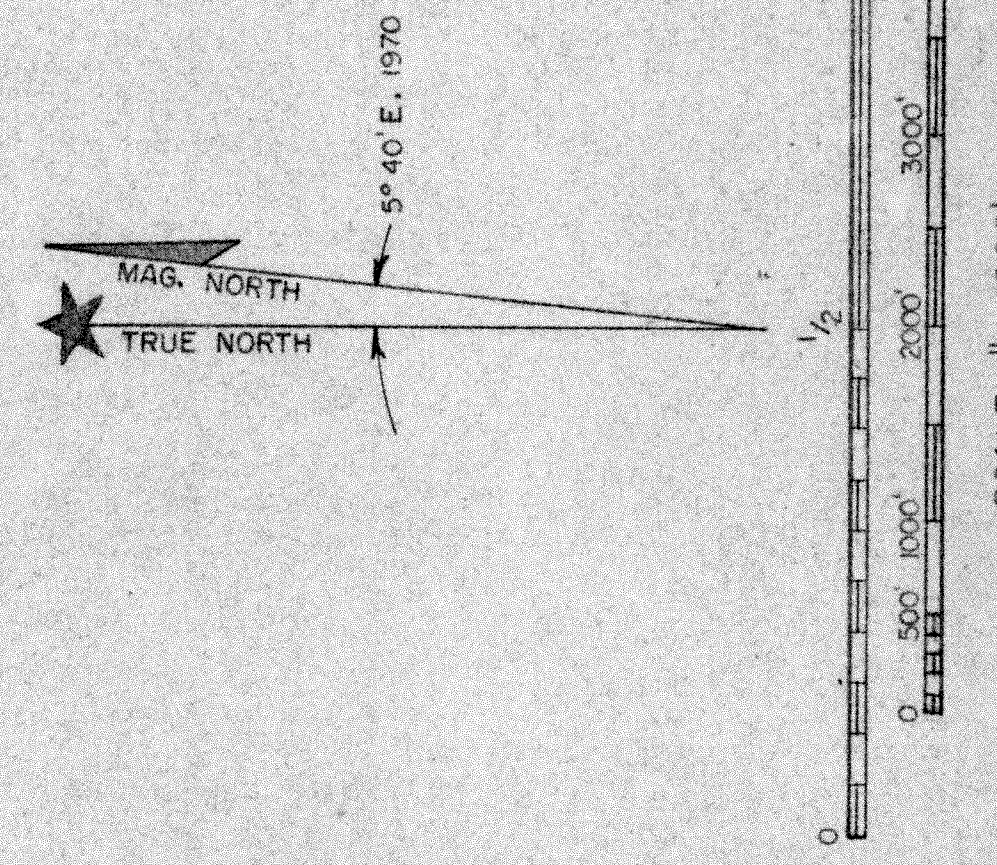
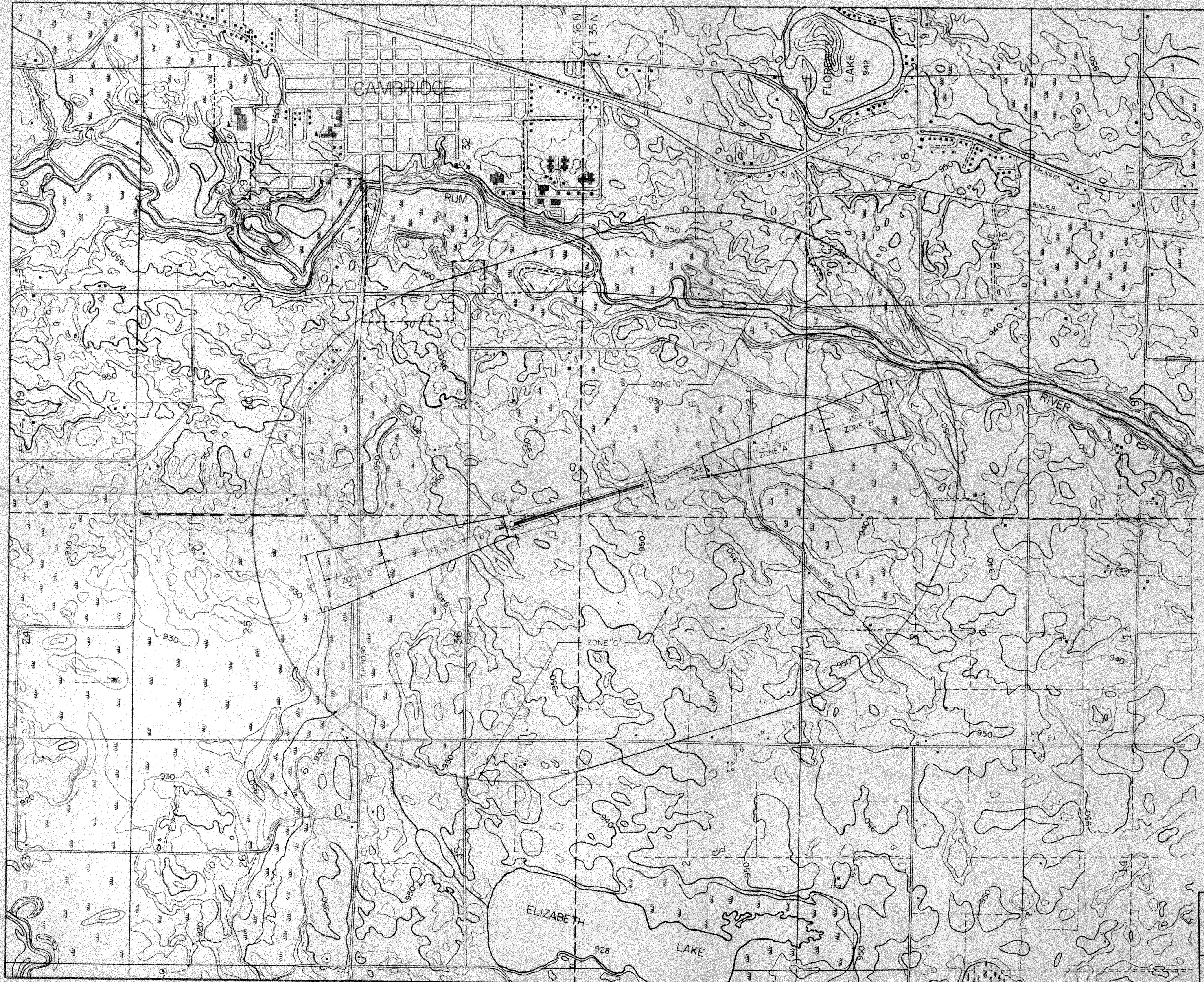

NOTES:
 1. TOPOGRAPHIC CONTOUR INTERVALS ARE 10' FEET
 DATUM IS MEAN SEA LEVEL ELEVATION
 2. EXISTING TOPOGRAPHIC SYMBOLS ARE THOSE
 USED BY THE U.S. GEOLOGICAL SURVEY

LEGEND
 ULTIMATE RUNWAY
 ZONE BOUNDARY
 TOPOGRAPHIC CONTOURS
 SECTION LINES
 CAMBRIDGE CORP. LIMITS

R 23 W
 R 24 W

CAMBRIDGE MUNICIPAL AIRPORT
 CAMBRIDGE, MINNESOTA
 LAND USE ZONING PLAN
 SHEET NO 3 OF 3 SHEETS